

SSS-174

SSS-175

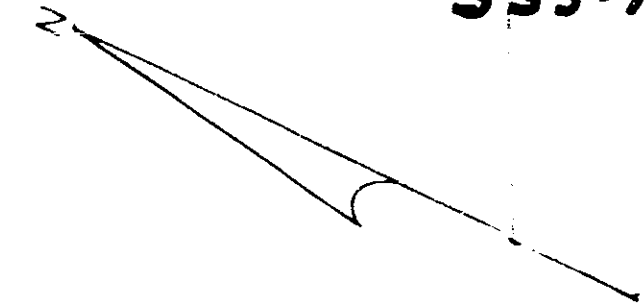

13.41 ACRES

ABNEY MILLS

ABNEY MILLS

LEGEND

- PROPERTY LINE & CORNER
- - - - - RIGHT-OF-WAY LINE
- ⊂ - - - - - CENTER LINE
- R/W RIGHT-OF-WAY
- N&C NAIL AND CAP
- I.P. IRON PIN

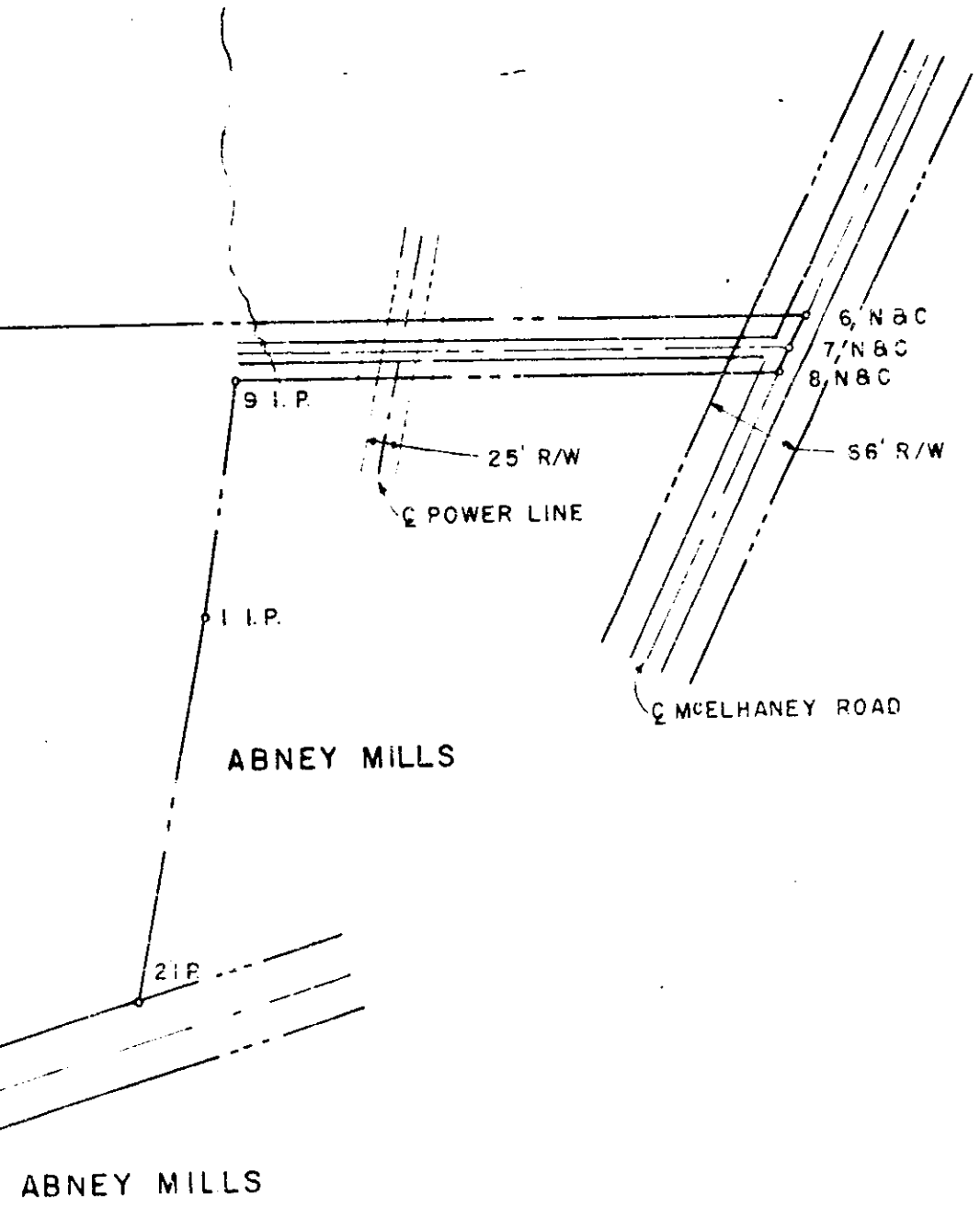

ABNEY MILLS

ABNEY MILLS

LEGEND

- PROPERTY LINE & CORNER
- - - - - RIGHT-OF-WAY LINE
- ⊂ - - - - - CENTER LINE
- R/W RIGHT-OF-WAY
- N&C NAIL AND CAP
- I.P. IRON PIN

LINE	BEARING	DISTANCE
1-2	S 77°-55' W	253.15'
2-3	N 39°-41' W	596.46'
3-4	N 13°-29' W	466.91'
4-5	N 65°-19' E	512.86'
5-6	S 23°-47' E	1513.63'
6-7	N 85°-13' W	23.90'
7-8	N 85°-23' W	17.00'
8-9	N 23°-47' W	376.18'
9-1	S 75°-52' W	375.09'

D ENGINEERS, INC.
WOOD, S. C.

REG NO. 1574

TOWN OF TRAVELERS REST
GREENVILLE COUNTY, S.C.

OWNER

PROPERTY SURVEY
WEST LAGOON SITE, S.C.

DRAWING TITLE

PROPERTY SURVEY
WEST LAGOON SITE

DRAWING TITLE

DRAWN: G.L.W.

CHECKED: J.M.M.

APPROVED: E.I.D.

SCALE:

1" = 100'

DATE

SEPT. 24, 1968

Recorded March 26, 1969 at 11:28 A. M., #22810.